

ACTUALIZACIÓN 21-01-2019

TUBOS REDONDOS

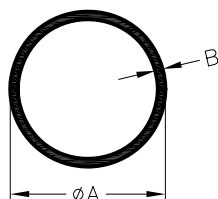

	A	B	PESO TEÓRICO	PERÍMETRO
	10.00	1.00	0.076	57
	10.00	1.20	0.090	55
	11.00	1.50	0.121	82
	13.00	1.20	0.120	74
	14.00	1.00	0.111	119
<b>11158</b>	16.00	4.60	0.446	71
	18.00	1.50	0.211	103
	18.50	1.35	0.197	108
	18.60	1.40	0.192	109
	19.00	2.00	0.289	107
	20.00	1.00	0.162	119
	20.00	1.30	0.206	118
	20.00	4.90	0.626	95
	22.00	1.25	0.220	130
	22.00	1.50	0.262	129
	22.00	2.00	0.340	126
	22.00	4.90	0.710	107
	22.00	6.00	0.815	100
	22.50	1.00	0.184	135
	25.00	1.30	0.261	149
	25.00	1.50	0.297	147
	25.00	2.00	0.397	145
	25.00	2.50	0.477	142
	25.00	3.00	0.560	138
<b>13027</b>	25.40	3.25	0.610	139
	27.00	1.00	0.221	164
	28.00	1.00	0.229	170
<b>32662</b>	29.49	1.37	0.327	177
	30.00	1.50	0.363	179
	30.00	2.00	0.475	176
<b>10282</b>	30.00	7.50	1.431	141
	31.70	4.70	1.076	170
<b>13026</b>	31.75	3.25	0.786	179
	32.00	1.65	0.424	191
<b>25912</b>	33.20	3.075	0.786	189
	34.00	1.50	0.413	204
	35.00	1.10	0.316	213
	35.00	1.50	0.426	211
<b>(NUEVO)</b>	35.00	2.00	0.560	207
	40.00	1.50	0.489	242
	40.00	2.60	0.823	235
	41.50	2.50	0.826	245
	41.50	3.50	1.143	242
	42.00	3.50	1.143	242
	42.00	4.00	1.291	239
	42.50	4.75	1.521	238
	43.50	1.50	0.534	264
	45.00	1.50	0.553	273
	48.00	3.00	1.150	283
	48.00	4.00	1.482	278
<b>13025</b>	48.40	4.47	1.666	276
	48.50	1.50	0.597	295
	50.00	1.40	0.578	305
	50.00	1.50	0.617	305
	50.00	2.00	0.815	302
	50.00	3.00	1.196	295
	50.00	3.50	1.380	292
	51.00	2.00	0.832	308
	51.50	3.00	1.234	305
	51.50	21.90	5.499	186

continúa en la siguiente página

Antes de realizar un pedido deben solicitar el envío del plano, para comprobar todos los aspectos del perfil.

ACTUALIZACIÓN 21-01-2019

continuación de página anterior

TUBOS REDONDOS

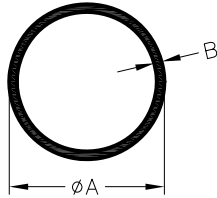

	A	B	PESO TEÓRICO	PERÍMETRO
<b>(NUEVO)</b>	55.00	2.00	0.899	333
	55.00	6.00	2.495	308
	60.00	1.40	0.697	368
	60.00	3.00	1.450	358
	60.00	3.50	1.677	355
	60.00	5.00	2.333	345
	62.00	2.00	1.018	377
	64.00	6.00	2.951	364
	70.00	6.00	3.256	402
	70.00	8.50	4.434	387
	70.00	16.50	7.488	336
	75.00	1.30	0.813	463
<b>35043</b>	80.00	1.50	0.999	493
	80.00	2.00	1.323	490
	86.00	7.00	4.691	496
	90.00	5.00	3.605	534
<b>10060</b>	100.50 <sup>(*)</sup>	1.18	0.859	624
	101.60 <sup>(*)</sup>	1.12	0.955	631
<b>10059</b>	105.00	2.50	2.174	644
	112.00 <sup>(*)</sup>	1.20	1.128	696
<b>10058</b>	120.00	8.00	7.600	704
<b>10057</b>	127.00 <sup>(*)</sup>	1.23	1.312	790
	132.00 <sup>(*)</sup>	1.25	1.386	822
	140.00	2.50	2.916	864
	162.60	5.00	6.684	990
	210.00	5.00	8.694	1288

(\*) TUBOS REDONDOS ESPECIALES

TUBOS CUADRADOS

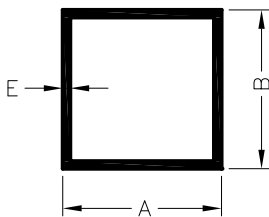

	A	B	E	PESO TEÓRICO	PERÍMETRO
	20	20	1.30	0.262	148
	20	20	2.00	0.389	143
<b>17284</b>	21.5	21.5	3.00	0.551	136
	25	25	2.00	0.489	180
<b>32276</b>	25	25	2.00	0.497	183
	28	28	3.00	0.775	191
	30	30	2.00	0.597	219
<b>32199</b>	30	30	2.00	0.605	223
	35	35	1.80	0.645	265
	40	40	1.30	0.543	309
	40	40	1.50	0.621	307
	40	40	2.00	0.821	303
	50	50	1.30	0.683	389
	60	60	1.30	0.823	469
	60	60	2.00	1.253	463
	60	60	3.00	1.847	455
	80	80	1.40	1.188	628
	80	80	1.50	1.271	627
	80	80	2.00	1.684	623
	80	80	4.00	3.272	605
	100	100	2.00	2.117	783
	100	100	4.00	4.147	767
	120	120	2.00	2.549	943
<b>45203</b>	125	125	2.50	3.307	979
<b>25221</b>	134.5	134.5	3.50	4.903	1038
<b>25220</b>	144	144	4.00	5.909	1094
	150	150	3.00	4.763	1174

Esquinas Radio 2mm

Esquinas Radio 2mm

Esquinas Radio 0.5 mm

ACTUALIZACIÓN 21-01-2019

	A	B	E	PESO TEÓRICO	PERÍMETRO	
	17.50	10.00	1.30	0.174	99	
<b>11229</b>	20	10.00	1.30	0.191	109	
	25	10.00	2.00	0.335	123	Esquinas de R0.3 mm
	25.20	8.20	1.50	0.246	121	
	27.7	21.50	1.50	0.374	184	
<b>25534</b>	30	10.00	1.50	0.291	144	
	30	15.00	1.30	0.297	169	
	30	15.00	2.00	0.435	159	
	30	20.00	1.30	0.332	189	
	30	20.00	2.00	0.497	183	
	31	22.50	1.30	0.356	204	
<b>17269</b>	33	22.00	2.50	0.679	198	
<b>1711</b>	38	25.00	2.00	0.635	233	
	40	10.00	1.30	0.332	188	
	40	15.00	2.00	0.543	199	
	40	20.00	1.30	0.402	229	
	40	20.00	1.50	0.462	227	
<b>17270</b>	40	28.00	2.50/3.00	0.913	248	
<b>11323</b>	40	30.00	2.50/2.00	0.810	261	
	40	30.00	2.00	0.712	264	
	42	27.00	2.50	0.850	252	Esquinas de R2.50 mm
<b>25929</b>	45	30.00	2.00	0.788	279	Esquinas: int=3/ext=0.3
	45	35.00	2.00	0.820	304	
	47.50	42.50	2.00	0.928	344	
	50	10.00	1.40	0.432	228	
	50	20.00	1.50	0.542	267	
	50	25.00	1.35	0.527	288	
	50	30.00	2.00	0.820	304	
	50	30.00	3.00	1.198	295	
	60	10.00	1.40	0.508	268	Esquinas de R0.3 mm
	60	20.00	1.30	0.543	309	
	60	20.00	2.00	0.821	303	
	60	30.00	1.50	0.705	348	
	60	40.00	1.30	0.683	389	
	60	40.00	1.70	0.887	386	
	60	40.00	2.00	1.037	383	
	60	50.00	3.00	1.685	415	
	60	50.00	5.00	2.643	390	
	67	38.00	2.00	1.091	403	
	70	16.00	1.00	0.438	324	Esquinas de R4.0 mm
	70	20.00	1.30	0.613	349	
	75	40.00	1.50	0.907	447	
<b>45244</b>	80	15.00	1.20	0.599	369	Esquinas de R0.5 mm
	80	20.00	1.40	0.734	388	
	80	38.00	2.00	1.231	455	
	80	40.00	1.40	0.887	468	
	80	40.00	2.00	1.253	463	
	80	50.00	2.00	1.360	503	
<b>10487</b>	90	19.00	1.50	0.859	423	
	100	20.00	1.30	0.824	469	
	100	20.00	1.50	0.948	467	
	100	40.00	1.40	1.037	548	
	100	45.00	1.40	1.112	588	
	100	50.00	2.00	1.577	583	
	100	90.00	6.00	5.765	710	Esquinas de R1.00 mm
	120	40.00	1.50	1.272	627	
	120	60.00	2.00	1.901	703	
	120	80.00	3.00	3.143	776	
<b>10316</b>	121	20.00	3.00	2.190	538	
	123	75.00	2.00	2.093	774	Esquinas de R1.00 mm
	125	50.00	4.60	4.117	663	
	145	40.00	2.00	1.955	723	
	150	50.00	2.00	2.117	783	Esquinas de R0.3 mm
	160	75.00	2.50	3.103	920	
	160	75.00	8.00	9.459	876	
<b>32873</b>	180	30.00	2.20	2.440	821	
	200	40.00	3.00	3.789	928	
	200	80.00	2.50	3.712	1099	
	200	100.00	4.00	2.336	1167	Esquinas de R0.3 mm
	200	100.00	8.00	4.544	1135	Esquinas de R0.3 mm
	200	100.00	10.00	5.600	1119	Esquinas de R0.3 mm

TUBOS RECTANGULARES

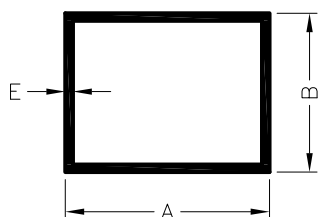

ACTUALIZACIÓN 21-01-2019

	A	B	E	PESO TEÓRICO	PERÍMETRO
<b>4214</b>	15	15	1.50	0.113	58
	20	15	1.15	0.119	79
	20	15	2.00	0.178	69
	20	20	1.15	0.119	79
	20	20	1.30	0.135	79
	20	20	1.50	0.154	78
	20	20	2.00	0.205	79
	25	15	1.40	0.146	79
<b>4216</b>	25	25	1.30	0.170	99
	25	25	2.00	0.259	99
	25	25	3.00	0.380	99
	30	20	1.50	0.196	99
	30	20	2.00	0.259	99
	30	30	1.15	0.181	119
	30	30	1.30	0.205	119
	30	30	1.50	0.235	118
	30	30	2.00	0.313	119
	40	20	1.30	0.205	119
	40	20	2.00	0.313	120
	40	30	3.00	0.543	139
	40	40	1.30	0.275	159
	40	40	2.00	0.421	159
	40	40	3.00	0.623	159
	40	40	4.00	0.821	159
	42	30	1.70	0.321	159
	50	10	2.00	0.313	119
	50	16	3.00	0.510	131
	50	20	2.00	0.367	139
50	30	1.50	0.318	159	
50	30	1.70	0.359	160	
50	30	2.00	0.421	159	
50	45	2.00	0.502	189	
50	50	1.50	0.397	198	
50	50	2.00	0.529	199	
50	50	3.00	0.785	199	
50	50	4.50	1.160	199	
50	50	5.00	1.282	200	
<b>(NUEVO)66089</b>	53	25	2.00	0.410	155
	53	35	1.50	0.350	175
	60	15	1.50	0.297	149
	60	20	2.00	0.421	159
	60	40	1.40	0.373	199
	60	40	1.70	0.451	199
	60	40	2.00	0.529	199
	60	40	2.50	0.659	198
	60	40	4.00	1.037	199
	60	60	1.50	0.478	239
	60	60	2.00	0.637	239
	65	30	1.50	0.378	189
	70	30	2.00	0.529	199
	70	52	3.00	0.963	243
<b>(NUEVO)</b>	70	70	4.00	1.469	279
	75	75	10.00	3.780	299
	80	20	2.00	0.529	199
	80	30	2.00	0.583	219
	80	40	1.50	0.481	239
	80	40	2.00	0.637	240
	80	40	3.00	0.948	239
<b>13502</b>	81.30	81.30	1.30	0.565	339
	90	60	1.40	0.561	299
	100	30	2.00	0.691	259
	100	40	3.00	1.109	279
	100	50	9.25	3.515	299
	100	100	1.80	0.963	399

ÁNGULOS

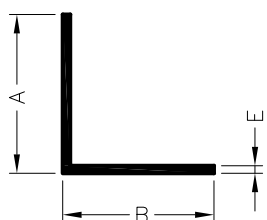

Esquinas de R0.3 mm

Esquinas de R0.3 mm

Esquinas de R1y R0.3mm

Esquinas de R0.3 mm

Esquinas de R0.3 mm

continúa en la siguiente página

Antes de realizar un pedido deben solicitar el envío del plano, para comprobar todos los aspectos del perfil.

ACTUALIZACIÓN 21-01-2019

continuación de página anterior

ÁNGULOS

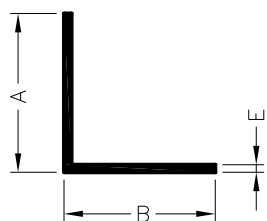

	A	B	E	PESO TEÓRICO	PERÍMETRO
<b>11233</b>	100	100	6.00	3.142	399
	100	100	10.0	5.130	399
	110	30	1.50	0.559	278
	120	20	2.00	0.745	279
	120	40	1.70	0.726	320
	120	40	3.00	1.272	319
	120	50	2.00	0.907	340
	150	150	8.00	6.304	598
	155	42	5.00	2.591	393
	180	45	3.5/4.0	2.177	446
<b>11307</b>	220	55	3.5/4.0	2.663	546

Esquinas de R0.3 mm

PERFILES DE "U"

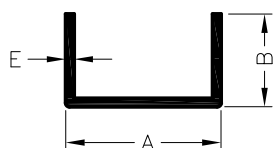

	A	B	E	PESO TEÓRICO	PERÍMETRO
<b>10191</b>	10.00	15.00	1.50	0.150	76
	12.00	28.00	2.00	0.335	130
	12.60	12.10	1.20	0.105	74
	13.00	10.00	1.50	0.122	62
<b>8030</b>	14.30	20.00	0.85	0.121	107
<b>10506</b>	16.00	12.50	1.50	0.153	78
	16.00	15.00	1.30	0.152	89
<b>8031</b>	16.00	25.00	1.30	0.222	129
	17.65	20.00	0.80	0.121	114
	18.80	12.50	1.50	0.165	83
	18.80	14.00	1.20	0.143	90
	20.00	20.00	1.30	0.202	117
	25.00	15.00	2.00	0.273	104
	27.50	20.00	1.30	0.227	132
<b>10315</b>	30.00	121.0	6.00	4.223	529
<b>6551</b>	30.50	40.00	2.70	0.767	215
<b>10031</b>	32.40	21.80	1.50	0.294	147
	34.70	25.50	1.80	0.397	166
	36.00	24.00	3.00	0.631	161
<b>25681</b>	36.40	36.60	1.50	0.431	215
	38.50	52.00	3.00	1.105	278
<b>16258</b>	40.00	30.00	3.5/2.5	0.719	188
<b>11425</b>	40.00	40.00	4.00	1.210	231
<b>10314</b>	40.00	121.0	6.00	4.385	549
	43.00	27.00	3.00	0.737	187
<b>17274</b>	46.80	43.00	3.0/3.5	1.082	257
	50.00	30.00	2.00	0.572	215
	50.00	30.00	3.00	0.842	213
	52.00	70.00	3.00	1.506	243
	52.00	90.00	3.00	1.830	457
	60.00	40.00	4.00	1.426	271
	<b>7444</b>	60.60	102.00	5.00	3.629
76.00		50.00	4.00	1.814	343
80.00		20.00	2.00	0.626	235
<b>10280</b>	100.0	50.00	5.00	2.565	389
	100.0	121.0	8.00	7.052	664

ACTUALIZACIÓN 21-01-2019

PLETINAS

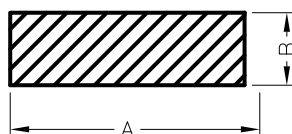

	A	B	PESO TEÓRICO	PERÍMETRO	
	8	5	0.108	25	
<b>16524</b>	10	3	0.081	25	
	10	5	0.135	30	Esquinas de R0.25 mm
	10	8	0.216	35	
	15	3	0.121	36	
	16	3	0.130	37	
	16	6	0.259	43	
	16	8	0.346	47	
<b>11198</b>	17	5.50	0.251	44	
	20	2	0.107	43	
	20	3	0.162	45	
	20	4	0.216	47	
	20	5	0.270	49	
	20	10	0.540	60	
<b>16729</b>	21	2.00	0.113	46	
	22	1.50	0.089	46	
<b>10142</b>	25	2.50	0.167	54	
	25	20	1.350	89	
	30	3	0.243	65	
	30	15	1.215	89	
<b>11194</b>	34.90	4.90	0.462	78	
	40	4	0.432	88	
	40	7	0.756	93	
	40	8	0.863	95	
	40	10	1.075	97	
<b>10089</b>	40	15	1.620	109	
	41	2	0.221	85	
	44	3	0.356	93	
<b>6633</b>	49.65	1.45	0.194	101	
<b>11083</b>	50	2	0.270	104	
	50	3	0.405	106	
	50	15	2.025	129	
	52	3	0.421	109	
	60	3	0.486	126	
<b>13725</b>	64	5	0.864	137	
	70	5	0.945	149	
	80	5	1.080	170	
	85	20	4.589	209	
	87	8	1.879	190	
<b>17001</b>	90	2.70	0.656	185	
<b>10091</b>	95	15	3.848	219	
	100	5	1.350	209	
	125	13	4.387	275	
	150	10	4.050	319	
	200	10	5.400	420	
	200	15	8.100	429	
	200	25	13.500	450	
<b>11267</b>	220	4	2.374	447	

CUADRADOS MACIZOS

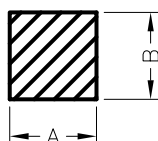

	A	B	PESO TEÓRICO	PERÍMETRO
	25	25	1.685	98
	30	30	2.430	119
	40	40	4.320	160
	50	50	6.749	199

ACTUALIZACIÓN 21-01-2019

REDONDOS MACIZOS

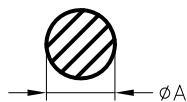

	A	PESO TEÓRICO	PERÍMETRO
	6	0.076	19
<b>10195</b>	8	0.135	25
	12	0.305	38
	20	0.848	63
	26	1.434	82
	30	1.909	94
<b>(NUEVO)</b>	47	4.684	148
<b>13028</b>	50.80	5.473	160

PLETINAS ESPECIALES

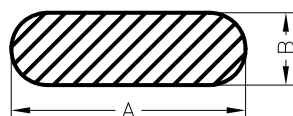

	A	B	PESO TEÓRICO	PERÍMETRO
<b>25500</b>	25	3	0.197	53
<b>10574</b>	40	5	0.526	86
<b>30283</b>	50	10	1.292	111
<b>10600</b>	85	25	5.375	199

PERFILES DE "T"

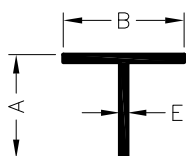

	A	B	E	PESO TEÓRICO	PERÍMETRO
	20	20	2.00	0.205	79
<b>30228</b>	20	40	2.00	0.313	119
	24	24	1.35	0.170	96
	45	110	2.00	0.828	306
	50	50	2.00	0.528	199
	50	50	5.00	1.282	199
	50	100	2.00	0.799	299
	60	40	2.50	0.678	199
	60	80	2.50	0.932	277
	60	100	2.50	1.115	319
	70	70	2.00	0.749	277
<b>17064</b>	100	110	2.50	1.400	419

TUBOS CON TABIQUE CENTRAL

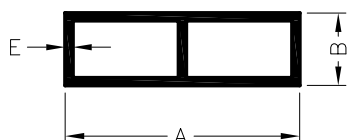

	A	B	E	PESO TEÓRICO	PERÍMETRO
	50	10	1.00	0.333	243
<b>32142</b>	80	15.80	1.10	0.591	396
<b>16278</b>	100	15	3.00	1.347	456
<b>8059</b>	100	20	1.30	0.894	500
<b>8013</b>	100	20	1.50	1.015	498
<b>9101</b>	120	25	1.55	1.283	601
<b>45208</b>	120	28	1.30	1.109	629
<b>30036</b>	150	18	1.30	1.215	689
	190	18.60	1.70	1.954	846