

ACTUALIZACIÓN 06-03-2019

TUBOS REDONDOS

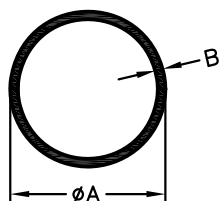

A	B	PESO TEÓRICO	PERÍMETRO
10.00	1.00	0.076	57
10.00	1.20	0.090	55
11.00	1.50	0.121	82
13.00	1.20	0.120	74
14.00	1.00	0.111	119
16.00	4.60	0.446	71
18.00	1.50	0.211	103
18.50	1.35	0.197	108
18.60	1.40	0.192	109
19.00	2.00	0.289	107
20.00	1.00	0.162	119
20.00	1.30	0.206	118
20.00	4.90	0.626	95
22.00	1.25	0.220	130
22.00	1.50	0.262	129
22.00	2.00	0.340	126
22.00	4.90	0.710	107
22.00	6.00	0.815	100
22.50	1.00	0.184	135
25.00	1.30	0.261	149
25.00	1.50	0.297	147
25.00	2.00	0.397	145
25.00	2.50	0.477	142
25.00	3.00	0.560	138
25.40	3.25	0.610	139
27.00	1.00	0.221	164
28.00	1.00	0.229	170
29.49	1.37	0.327	177
30.00	1.50	0.363	179
30.00	2.00	0.475	176
30.00	7.50	1.431	141
31.70	4.70	1.076	170
31.75	3.25	0.786	179
32.00	1.65	0.424	191
33.20	3.075	0.786	189
34.00	1.50	0.413	204
35.00	1.10	0.316	213
35.00	1.50	0.426	211
35.00	2.00	0.560	207
40.00	1.50	0.489	242
40.00	2.60	0.823	235
41.50	2.50	0.826	245
41.50	3.50	1.143	242
42.00	3.50	1.143	242
42.00	4.00	1.291	239
42.50	4.75	1.521	238
43.50	1.50	0.534	264
45.00	1.50	0.553	273
48.00	3.00	1.150	283
48.00	4.00	1.482	278
48.40	4.47	1.666	276
48.50	1.50	0.597	295
50.00	1.40	0.578	305
50.00	1.50	0.617	305
50.00	2.00	0.815	302
50.00	3.00	1.196	295
50.00	3.50	1.380	292
51.00	2.00	0.832	308
51.50	3.00	1.234	305
51.50	21.90	5.499	186

continúa en la siguiente página

ACTUALIZACIÓN 06-03-2019

continuación de página anterior

TUBOS REDONDOS

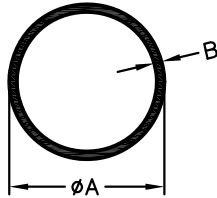

(NUEVO)

A	B	PESO TEÓRICO	PERÍMETRO
55.00	2.00	0.899	333
55.00	6.00	2.495	308
60.00	1.40	0.697	368
60.00	2.00	0.984	364
60.00	3.00	1.450	358
60.00	3.50	1.677	355
60.00	5.00	2.333	345
62.00	2.00	1.018	377
64.00	6.00	2.951	364
70.00	6.00	3.256	402
70.00	8.50	4.434	387
70.00	16.50	7.488	336
75.00	1.30	0.813	463
80.00	1.50	0.999	493
80.00	2.00	1.323	490
86.00	7.00	4.691	496
90.00	5.00	3.605	534
100.50 ^{*)}	1.18	0.859	624
101.60 ^{*)}	1.12	0.955	631
105.00	2.50	2.174	644
112.00 ^{*)}	1.20	1.128	696
120.00	8.00	7.600	704
127.00 ^{*)}	1.23	1.312	790
132.00 ^{*)}	1.25	1.386	822
140.00	2.50	2.916	864
162.60	5.00	6.684	990
210.00	5.00	8.694	1288

*) TUBOS REDONDOS ESPECIALES

TUBOS CUADRADOS

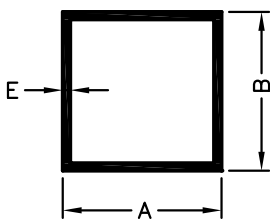

A	B	E	PESO TEÓRICO	PERÍMETRO
20	20	1.30	0.262	148
20	20	2.00	0.389	143
21.5	21.5	3.00	0.551	136
25	25	2.00	0.489	180
25	25	2.00	0.497	183
28	28	3.00	0.775	191
30	30	2.00	0.597	219
30	30	2.00	0.605	223
35	35	1.80	0.645	265
40	40	1.30	0.543	309
40	40	1.50	0.621	307
40	40	2.00	0.821	303
50	50	1.30	0.683	389
60	60	1.30	0.823	469
60	60	2.00	1.253	463
60	60	3.00	1.847	455
(NUEVO) 63.50	63.50	8.00	4.795	443
80	80	1.40	1.188	628
80	80	1.50	1.271	627
80	80	2.00	1.684	623
80	80	4.00	3.272	605
100	100	2.00	2.117	783
100	100	4.00	4.147	767
120	120	2.00	2.549	943
125	125	2.50	3.307	979
134.5	134.5	3.50	4.903	1038
144	144	4.00	5.909	1094
150	150	3.00	4.763	1174

Esquinas Radio 2mm

Esquinas Radio 2mm

Esquinas Radio 0.5 mm

Esquinas Radio 0.5 mm

ACTUALIZACIÓN 06-03-2019

A	B	E	PESO TEÓRICO	PERÍMETRO	
17.50	10.00	1.30	0.174	99	
20	10.00	1.30	0.191	109	
25	10.00	2.00	0.335	123	Esquinas de R0.3 mm
25.20	8.20	1.50	0.246	121	
27.7	21.50	1.50	0.374	184	
30	10.00	1.50	0.291	144	
30	15.00	1.30	0.297	169	
30	15.00	2.00	0.435	159	
30	20.00	1.30	0.332	189	
30	20.00	2.00	0.497	183	
31	22.50	1.30	0.356	204	
33	22.00	2.50	0.679	198	
38	25.00	2.00	0.635	233	
40	10.00	1.30	0.332	188	
40	15.00	2.00	0.543	199	
40	20.00	1.30	0.402	229	
40	20.00	1.50	0.462	227	
40	28.00	2.50/3.00	0.913	248	
40	30.00	2.50/2.00	0.810	261	
40	30.00	2.00	0.712	264	
42	27.00	2.50	0.850	252	Esquinas de R2.50 mm
45	30.00	2.00	0.788	279	Esquinas: int=3/ext=0.3
45	35.00	2.00	0.820	304	
47.50	42.50	2.00	0.928	344	
50	10.00	1.40	0.432	228	
50	20.00	1.50	0.542	267	
50	25.00	1.35	0.527	288	
50	30.00	2.00	0.820	304	
50	30.00	3.00	1.198	295	
60	10.00	1.40	0.508	268	Esquinas de R0.3 mm
60	20.00	1.30	0.543	309	
60	20.00	2.00	0.821	303	
60	30.00	1.50	0.705	348	
60	40.00	1.30	0.683	389	
60	40.00	1.70	0.887	386	
60	40.00	2.00	1.037	383	
60	50.00	3.00	1.685	415	
60	50.00	5.00	2.643	390	
67	38.00	2.00	1.091	403	
70	16.00	1.00	0.438	324	Esquinas de R4.0 mm
70	20.00	1.30	0.613	349	
75	40.00	1.50	0.907	447	
80	15.00	1.20	0.599	369	Esquinas de R0.5 mm
80	20.00	1.40	0.734	388	
80	38.00	2.00	1.231	455	
80	40.00	1.40	0.887	468	
80	40.00	2.00	1.253	463	
80	50.00	2.00	1.360	503	
90	19.00	1.50	0.859	423	
100	20.00	1.30	0.824	469	
100	20.00	1.50	0.948	467	
100	40.00	1.40	1.037	548	
100	45.00	1.40	1.112	588	
100	50.00	2.00	1.577	583	
100	90.00	6.00	5.765	710	Esquinas de R1.00 mm
120	40.00	1.50	1.272	627	
120	60.00	2.00	1.901	703	
120	80.00	3.00	3.143	776	
121	20.00	3.00	2.190	538	
123	75.00	2.00	2.093	774	Esquinas de R1.00 mm
125	50.00	4.60	4.117	663	
145	40.00	2.00	1.955	723	
150	50.00	2.00	2.117	783	Esquinas de R0.3 mm
160	75.00	2.50	3.103	920	
160	75.00	8.00	9.459	876	
180	30.00	2.20	2.440	821	
200	40.00	3.00	3.789	928	
200	80.00	2.50	3.712	1099	
200	100.00	4.00	2.336	1167	Esquinas de R0.3 mm
200	100.00	8.00	4.544	1135	Esquinas de R0.3 mm
200	100.00	10.00	5.600	1119	Esquinas de R0.3 mm

TUBOS RECTANGULARES

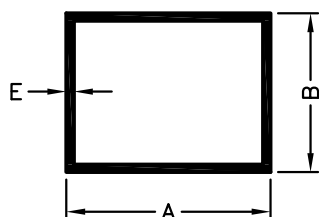

ACTUALIZACIÓN 06-03-2019

A	B	E	PESO TEÓRICO	PERÍMETRO	
15	15	1.50	0.113	58	
20	15	1.15	0.119	79	
20	15	2.00	0.178	69	
20	20	1.15	0.119	79	
20	20	1.30	0.135	79	
20	20	1.50	0.154	78	
20	20	2.00	0.205	79	
25	15	1.40	0.146	79	
25	25	1.30	0.170	99	
25	25	2.00	0.259	99	
25	25	3.00	0.380	99	
30	20	1.50	0.196	99	
30	20	2.00	0.259	99	
30	30	1.15	0.181	119	
30	30	1.30	0.205	119	
30	30	1.50	0.235	118	
30	30	2.00	0.313	119	
40	20	1.30	0.205	119	
40	20	2.00	0.313	120	
40	30	3.00	0.543	139	
40	40	1.30	0.275	159	
40	40	2.00	0.421	159	
40	40	3.00	0.623	159	Esquinas de R0.3 mm
40	40	4.00	0.821	159	
42	30	1.70	0.321	159	
50	10	2.00	0.313	119	
50	16	3.00	0.510	131	
50	20	2.00	0.367	139	
50	30	1.50	0.318	159	
50	30	1.70	0.359	160	Esquinas de R0.3 mm
50	30	2.00	0.421	159	
50	45	2.00	0.502	189	
50	50	1.50	0.397	198	
50	50	2.00	0.529	199	
50	50	3.00	0.785	199	
50	50	4.50	1.160	199	
50	50	5.00	1.282	200	
53	25	2.00	0.410	155	
53	35	1.50	0.350	175	Esquinas de R1y R0.3mm
60	15	1.50	0.297	149	
60	20	2.00	0.421	159	
60	40	1.40	0.373	199	
60	40	1.70	0.451	199	
60	40	2.00	0.529	199	
60	40	2.50	0.659	198	
60	40	4.00	1.037	199	
60	60	1.50	0.478	239	
60	60	2.00	0.637	239	
65	30	1.50	0.378	189	Esquinas de R0.3 mm
70	30	2.00	0.529	199	
70	52	3.00	0.963	243	
70	70	4.00	1.469	279	
75	75	10.00	3.780	299	Esquinas de R0.3 mm
80	20	2.00	0.529	199	
80	30	2.00	0.583	219	
80	40	1.50	0.481	239	
80	40	2.00	0.637	240	
80	40	3.00	0.948	239	
81.30	81.30	1.30	0.565	339	
90	60	1.40	0.561	299	
100	30	2.00	0.691	259	
100	40	3.00	1.109	279	
100	50	9.25	3.515	299	
(NUEVO) 100	75	3.00	2.737	349	Esquinas de R0.5 mm

ÁNGULOS

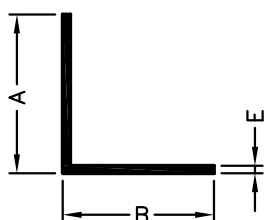

continúa en la siguiente página

Antes de realizar un pedido deben solicitar el envío del plano, para comprobar todos los aspectos del perfil.

ACTUALIZACIÓN 06-03-2019

continuación de página anterior

ÁNGULOS

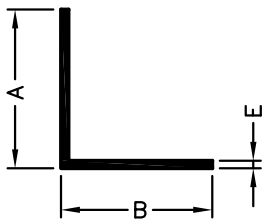

A	B	E	PESO TEÓRICO	PERÍMETRO
100	100	1.80	0.963	399
100	100	6.00	3.142	399
100	100	10.0	5.130	399
110	30	1.50	0.559	278
120	20	2.00	0.745	279
120	40	1.70	0.726	320
120	40	3.00	1.272	319
120	50	2.00	0.907	340
150	150	8.00	6.304	598
155	42	5.00	2.591	393
180	45	3.5/4.0	2.177	446
220	55	3.5/4.0	2.663	546

Esquinas de R0.3 mm

PERFILES DE "U"

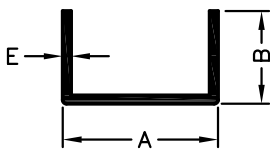

A	B	E	PESO TEÓRICO	PERÍMETRO
10.00	15.00	1.50	0.150	76
12.00	28.00	2.00	0.335	130
12.60	12.10	1.20	0.105	74
13.00	10.00	1.50	0.122	62
14.30	20.00	0.85	0.121	107
16.00	12.50	1.50	0.153	78
16.00	15.00	1.30	0.152	89
16.00	25.00	1.30	0.222	129
17.65	20.00	0.80	0.121	114
18.80	12.50	1.50	0.165	83
18.80	14.00	1.20	0.143	90
20.00	20.00	1.30	0.202	117
25.00	15.00	2.00	0.273	104
27.50	20.00	1.30	0.227	132
30.00	121.0	6.00	4.223	529
30.50	40.00	2.70	0.767	215
32.40	21.80	1.50	0.294	147
34.70	25.50	1.80	0.397	166
36.00	24.00	3.00	0.631	161
36.40	36.60	1.50	0.431	215
38.50	52.00	3.00	1.105	278
40.00	30.00	3.5/2.5	0.719	188
40.00	40.00	4.00	1.210	231
40.00	121.0	6.00	4.385	549
43.00	27.00	3.00	0.737	187
46.80	43.00	3.0/3.5	1.082	257
50.00	30.00	2.00	0.572	215
50.00	30.00	3.00	0.842	213
52.00	70.00	3.00	1.506	243
52.00	90.00	3.00	1.830	457
60.00	40.00	4.00	1.426	271
60.60	102.00	5.00	3.629	511
76.00	50.00	4.00	1.814	343
80.00	20.00	2.00	0.626	235
100.0	50.00	5.00	2.565	389
100.0	121.0	8.00	7.052	664

ACTUALIZACIÓN 06-03-2019

PLETINAS

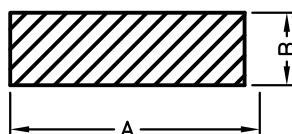

A	B	PESO TEÓRICO	PERÍMETRO	
8	5	0.108	25	
10	3	0.081	25	
10	5	0.135	30	Esquinas de R0.25 mm
10	8	0.216	35	
15	3	0.121	36	
16	3	0.130	37	
16	6	0.259	43	
16	8	0.346	47	
17	5.50	0.251	44	
20	2	0.107	43	
20	3	0.162	45	
20	4	0.216	47	
20	5	0.270	49	
20	10	0.540	60	
21	2.00	0.113	46	
22	1.50	0.089	46	
25	2.50	0.167	54	
25	20	1.350	89	
30	3	0.243	65	
30	15	1.215	89	
34.90	4.90	0.462	78	
40	4	0.432	88	
40	7	0.756	93	
40	8	0.863	95	
40	10	1.075	97	
40	15	1.620	109	
41	2	0.221	85	
44	3	0.356	93	
49.65	1.45	0.194	101	
50	2	0.270	104	
50	3	0.405	106	
50	15	2.025	129	
52	3	0.421	109	
60	3	0.486	126	
64	5	0.864	137	
70	5	0.945	149	
80	5	1.080	170	
85	20	4.589	209	
87	8	1.879	190	
90	2.70	0.656	185	
95	15	3.848	219	
100	5	1.350	209	
125	13	4.387	275	
150	10	4.050	319	
200	10	5.400	420	
200	15	8.100	429	
200	25	13.500	450	
220	4	2.374	447	

CUADRADOS MACIZOS

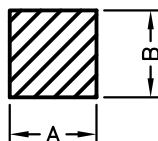

A	B	PESO TEÓRICO	PERÍMETRO
25	25	1.685	98
30	30	2.430	119
40	40	4.320	160
50	50	6.749	199

ACTUALIZACIÓN 06-03-2019

REDONDOS MACIZOS

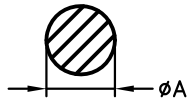

A	PESO TEÓRICO	PERÍMETRO
6	0.076	19
8	0.135	25
12	0.305	38
20	0.848	63
26	1.434	82
30	1.909	94
47	4.684	148
50.80	5.473	160

PLETINAS ESPECIALES

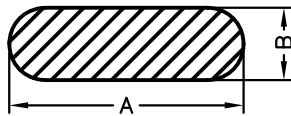

A	B	PESO TEÓRICO	PERÍMETRO
25	3	0.197	53
40	5	0.526	86
50	10	1.292	111
85	25	5.375	199

PERFILES DE "T"

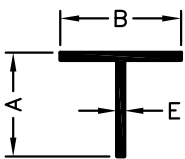

A	B	E	PESO TEÓRICO	PERÍMETRO
20	20	2.00	0.205	79
20	40	2.00	0.313	119
24	24	1.35	0.170	96
45	110	2.00	0.828	306
50	50	2.00	0.528	199
50	50	5.00	1.282	199
50	100	2.00	0.799	299
60	40	2.50	0.678	199
60	80	2.50	0.932	277
60	100	2.50	1.115	319
70	70	2.00	0.749	277
100	110	2.50	1.400	419

TUBOS CON TABIQUE CENTRAL

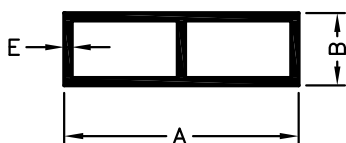

A	B	E	PESO TEÓRICO	PERÍMETRO
50	10	1.00	0.333	243
80	15.80	1.10	0.591	396
100	15	3.00	1.347	456
100	20	1.30	0.894	500
100	20	1.50	1.015	498
120	25	1.55	1.283	601
120	28	1.30	1.109	629
(NUEVO) 125	18	1.30	1.039	589
150	18	1.30	1.215	689
190	18.60	1.70	1.954	846

Esquinas de R0.5 mm